

PARCEL ID: 14-08-0003-0021-0000

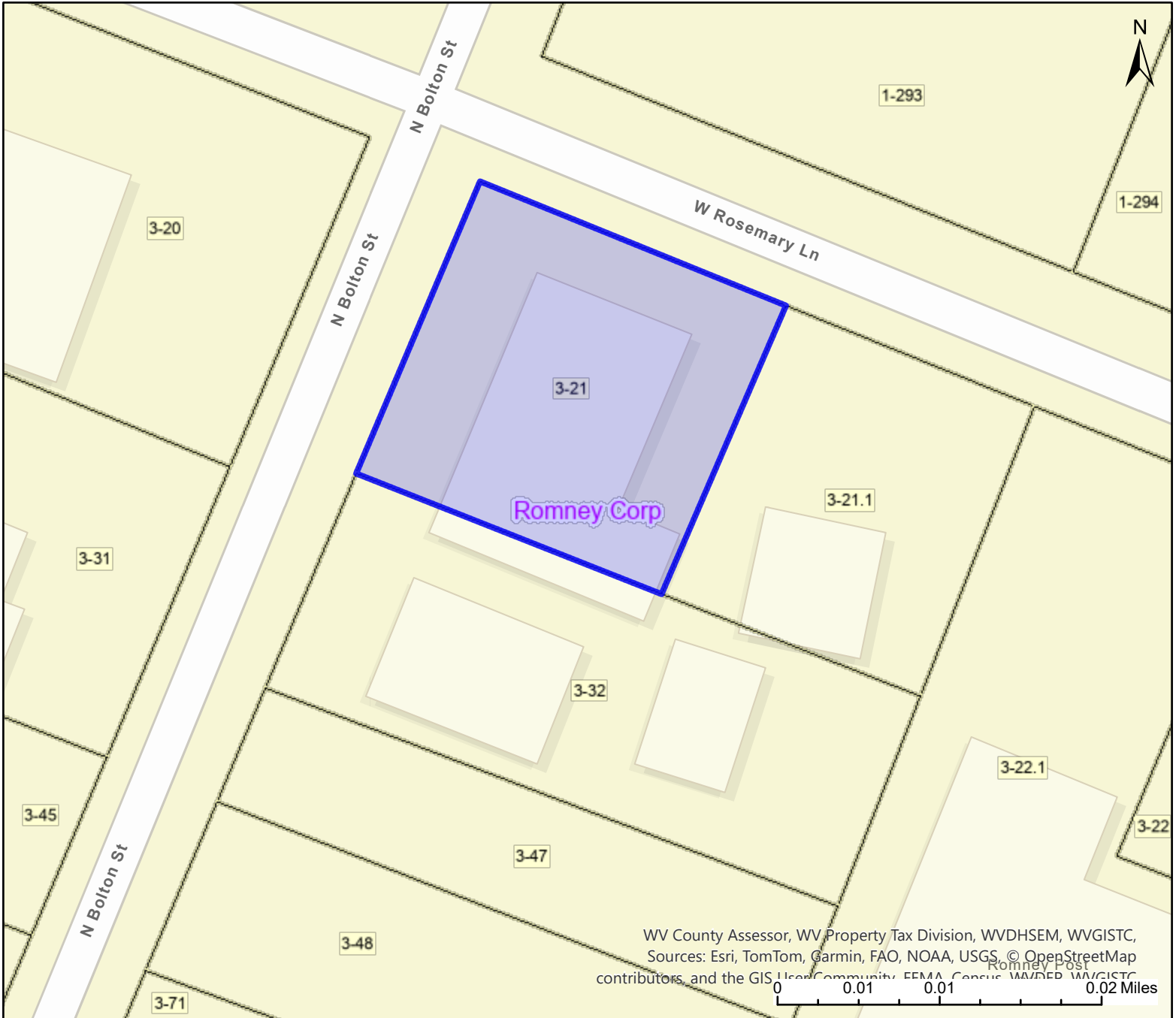

WV County Assessor, WV Property Tax Division, WVDHSEM, WVGISTC, Sources: Esri, TomTom, Garmin, FAO, NOAA, USGS, © OpenStreetMap contributors, and the GIS User Community, FEMA, Census, MA/DEP, WVGISTC

Legend

- WV Parcels
- Districts
- WV Parcels
- WVParcels

User Notes:

WV Property Viewer (<https://www.MapWV.gov/property>) is supported by WV State Tax Department and WV GIS Technical Center.

Map created on March 12, 2025

Owner(s):
CHILDS JOHN E JR

Address:
96 N BOLTON ST

Class Type:
Residential

Legal Description:
LOT 25 (PART) ROMNEY; .139A